

# S series

6 Axis Scara Robot

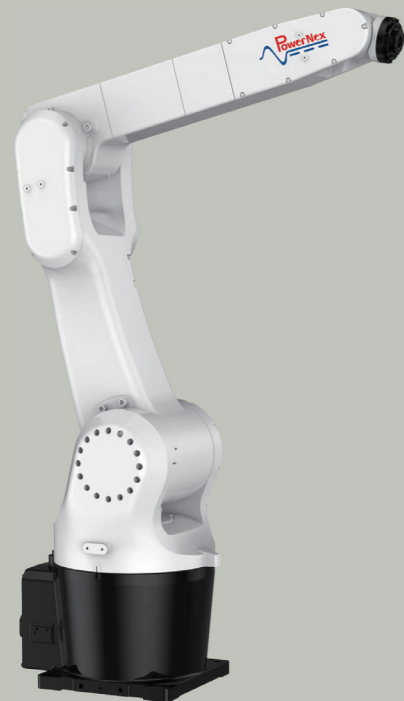

## Model S10-1106A

Max Motion Range 1106mm

Max payload 10kg

Repeatability  $\pm 0.03\text{mm}$

Mounting method Ground/Suspension

Weight 58kg

IP level IP54 (Wrist IP67)

### Parameters of each axis

Joint	#1	#2	#3	#4	#5	#6
Content						
Max Operating Speed	295°/s	295°/s	340°/s	480°/s	360°/s	705°/s
Max Motion Range	+170°/-170°	+130°/-96°	+65°/-195°	+200°/-200°	+120°/-120°	+360°/-360°

Electrical parameters Integrated Signal Source 12 Channels (30V, 0.5A)

Integrated Air Source 4- $\phi 4$ , 5bar

## Outer Dimensions and Motion Range

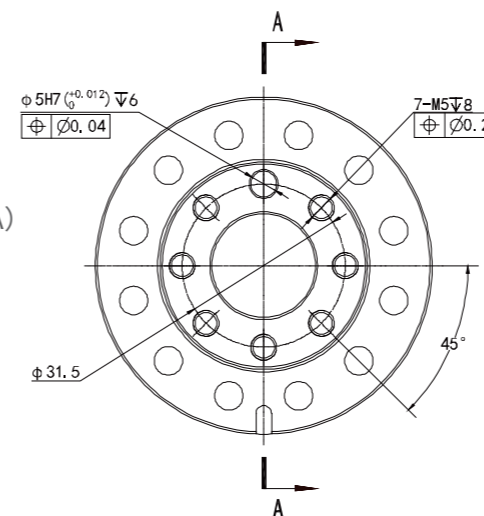
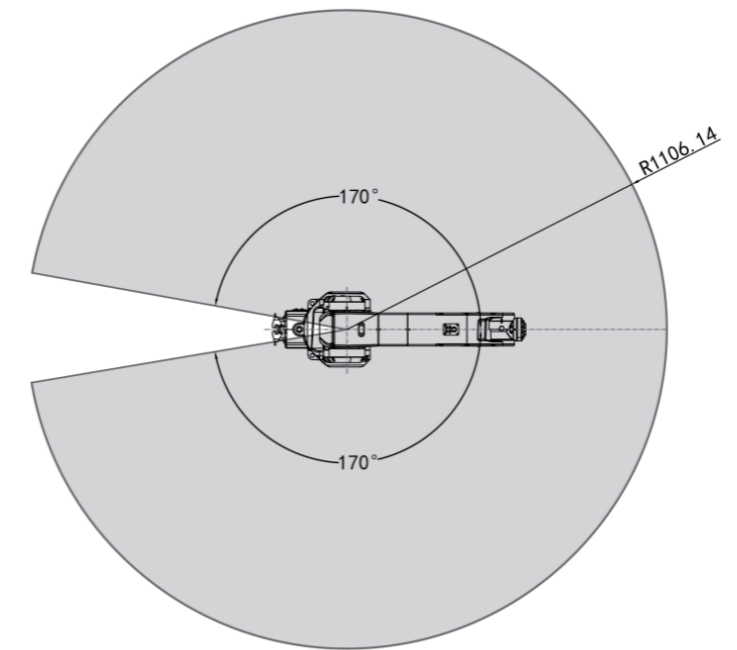
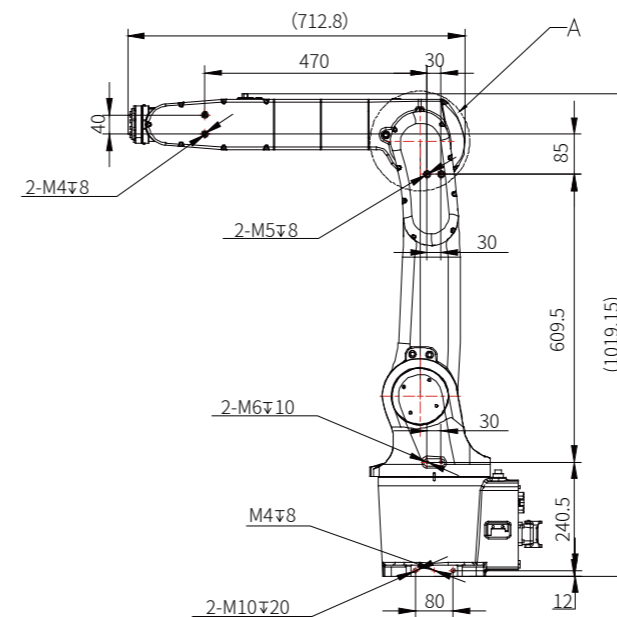
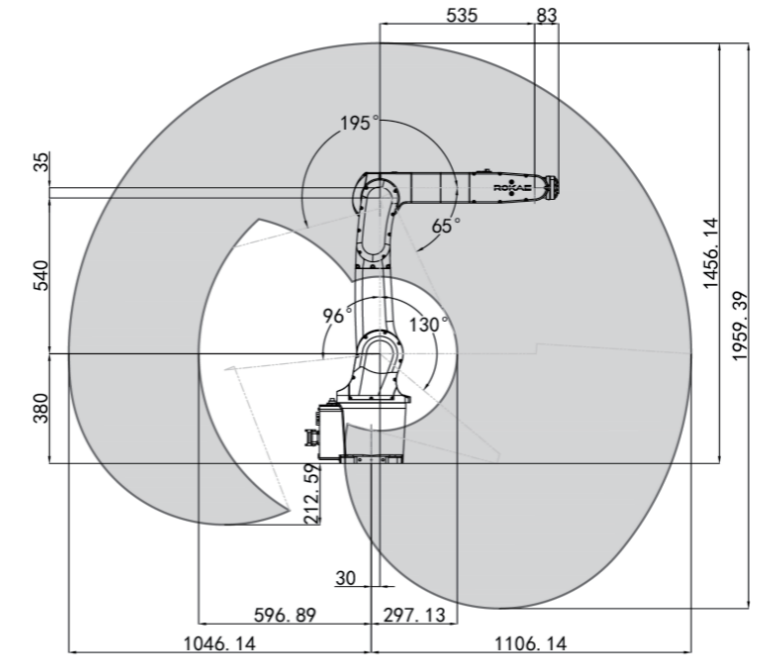
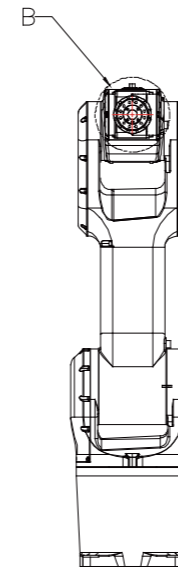

A-A

